

RUBY RUBY

MILTON

To Arrange an Inspection, Contact:

RICHARD FUSS
0400 707 425

Wyatt & Fuss Real Estate
www.wyattfuss.com.au

Three Bedroom Residence



A life less ordinary

For those who seek to never follow.
Fearlessly stepping into tomorrow.

A symmetrical photograph of two women with long blonde hair and sunglasses, sitting on the edge of a swimming pool. They are wearing light-colored, shimmering one-piece swimsuits. The background is the blue water of the pool, which is mirrored across a vertical axis. The overall mood is serene and summery.

RUBY RUBY

MILTON

Our luxury residences boast the utmost attention to detail. A discerning eye for design creates cohesive living spaces that exude elegance and sophistication. A translucent view over Brisbane where the river meets the sky.







Welcome Home

Greeted with luxury and warmth the moment you arrive with a welcoming concierge and an elegant entrance.

ARTIST IMPRESSION

Luxe Living

Enjoy the stunning Brisbane River and city skyline views from your living room, basking in a tranquil sense of calm.



ARTIST IMPRESSION

Opulent Abode

A beautifully adorned open-concept living area full where you can relish the breathtaking sceneries of the city skyline and the meandering Brisbane River. This seamless connection adds a luminous expansion to your lounge and dining space.



ARTIST IMPRESSION



ARTIST IMPRESSION

Elevating Tastes

Step into a contemporary masterpiece, featuring graceful curves and precise lines, crowned by luxurious marble counters, European Miele and Liebherr appliances, and a harmonious blend of rich textures.



Comfort Zone

Indulge in leisurely morning sleep-ins and start your day in a room filled with a natural light. Welcome to your personal oasis.



ARTIST IMPRESSION



Embrace Coziness

Delight in relaxing evening and step into your night in a room aglow with a gentle radiance. Welcome to your private haven beneath the stars.

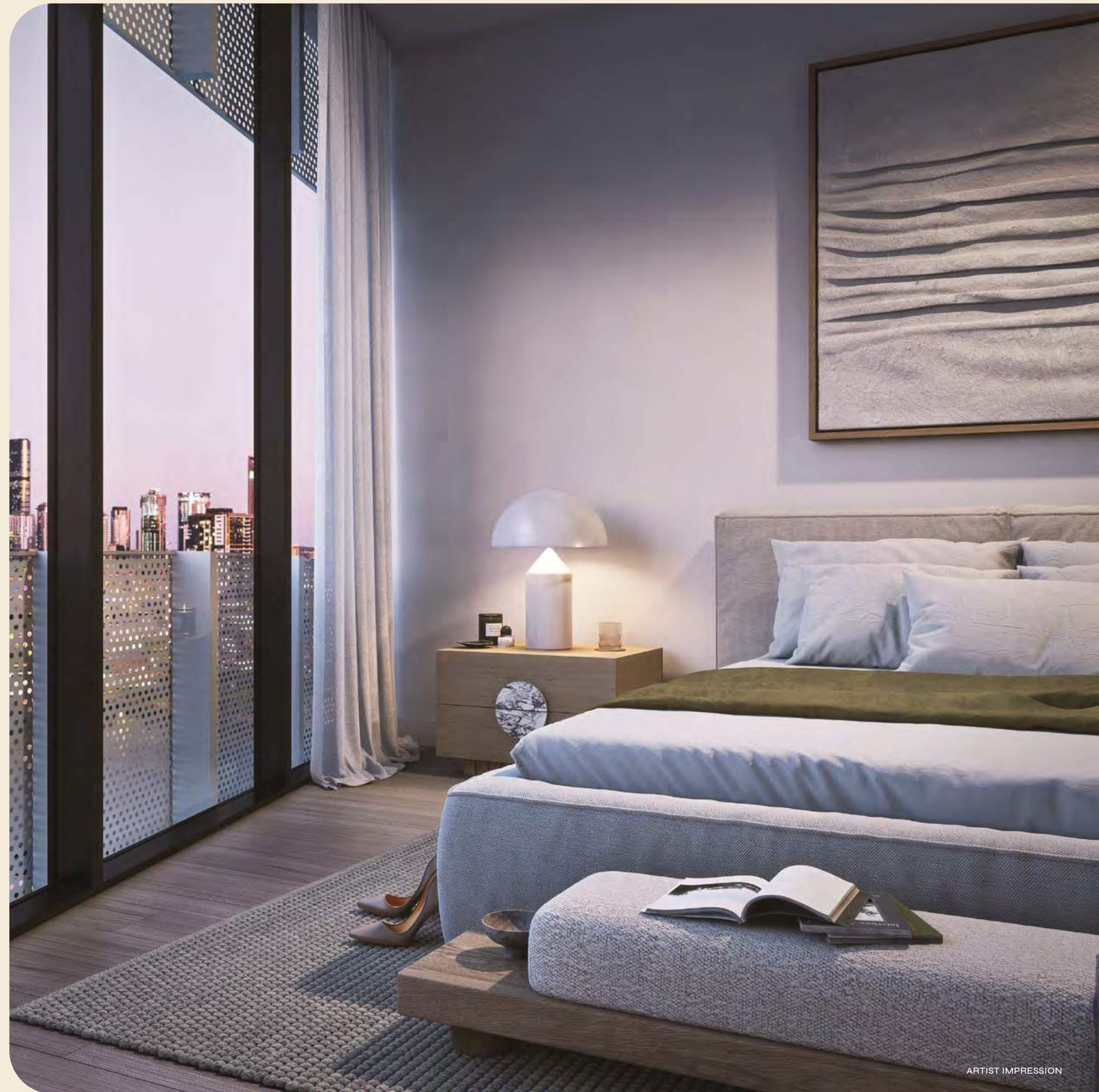

ARTIST IMPRESSION



ARTIST IMPRESSION



Dress to impress

Step into a realm of style with a luxury walk-in wardrobe designed to leave a lasting impression.



Refined Serenity

Experience everyday opulence with natural stone, rich timbers and exquisite hardware creating the perfect retreat for relaxation.





Beyond Compare

Indulge in sunrise breakfasts accompanied by your exclusive panoramic view of the city, or savour enchanting twilight dinner parties with your friends and family.

3A 3 Bed 3 Bath 2 Car

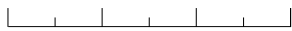

APARTMENTS	
13.02	14.02 15.02
16.02	

AREA	
Interior:	12m ²
Exterior:	1m ²
Total:	13m ²

LEGEND	
DW	Dishwasher
F	Fridge
OC	Outdoor Condenser Washing Machine
PB	Planter Box
PS	Privacy Screen
S	Storage
WR	Walk-In-Robe

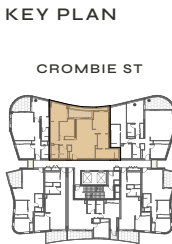

Indicative only. Dimensions, design features, floor areas, specifications and room configuration are for information only and are not guaranteed. The final product may differ from that depicted in this floorplan. Buyers should refer to the contract of sale for more information.

3B 3 Bed 3 Bath 2 Car

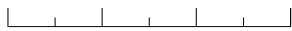

APARTMENTS	
14.03	15.03 16.03

AREA	
Interior:	13m ²
Exterior:	1m ²
Total:	14m ²

LEGEND	
DW	Dishwasher
F	Fridge
OC	Outdoor Condenser Washing Machine
PB	Planter Box
PS	Privacy Screen
S	Storage
WR	Walk-In-Robe

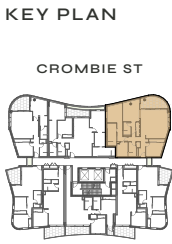

Indicative only. Dimensions, design features, floor areas, specifications and room configuration are for information only and are not guaranteed. The final product may differ from that depicted in this floorplan. Buyers should refer to the contract of sale for more information.



3D 3 Bed 3 Bath 2 Car

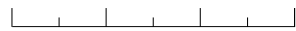

APARTMENTS

13.05

AREA

Interior:	13m ²
Exterior:	2m ²
Total:	15m ²

LEGEND

DW	Dishwasher	S	Storage	Robe
F	Fridge	OC	Outdoor Condenser	Washing Machine
PB	Plant	WR	Box	Walk-In-Robe
PS	Privacy Screen			

KEY PLAN

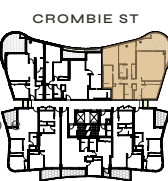

Indicative only. Dimensions, design features, floor areas, specifications and room configuration and so the final product may differ from that depicted in this floorplan. Buyers should refer to the relevant documents for more information.



View lines



Level 21



Level 16



Level 13

Interior specification – 3 bedrooms

KITCHEN	
Sink	Double Bowl Sink (refer to plans)
Mixer	Pull Out Single Lever Mixer
Cooktop	Miele Gas Cooktop 900mm*
Oven	Miele Oven 600mm*
Microwave/steam oven	Miele 600mm Steam oven with microwave*
Rangehood	Miele Rangehood 900mm*
Dishwasher	Miele Integrated Dishwasher 600mm*
Refrigerator	Liebherr Integrated Fridge / Freezer*
Splash back	Selected Natural Stone
Benchtop	Selected Natural Stone
Joinery Units	Laminate
Floor	Engineered Timber Floor
Light	Selected Recessed LED Downlights
BATHROOM	
Basin	Wall Hung Vanity and Sink with Storage Cabinetry
Basin Taps	Taps and Spout
Toilet Suite	Toilet Suite with Soft Close Seat
Shower Tapware	Single Lever Mixers, Rail Shower
Shower Screen	Semi-Frameless Glass
Mirror	Polished Edged Mirror
Accessories	Towel Rail, Toilet Roll Holder
Floor & Wall Tile	Selected Tile
Light	Feature Wall light & Selected Recessed LED Down lights
Bath	Freestanding Bath – Master Ensuite
LIVING AREAS AND BEDROOMS	
Flooring	Selected Engineered Timber Floor to Kitchen, Living & Master Bedroom Selected Carpet to Second Bedrooms and Study
Walls / Ceilings	Selected Paint Finish to Plasterboard
Skirtings & Architraves	Selected Paint Finish to Skirting and Architraves
Cornices	Square Set
Entry & Internal Doors	Flush Panel Door with Selected Door Hardware
Lighting	Selected Recessed LED Down lights
Wardrobe (3bedrooms)	Mirrored Sliding Door Robes with Hanging Rail and Shelf
Walk-in Robe (Selected 3bedrooms)	Open Robes with Hanging Rail and Shelf
GENERAL	
Windows	Aluminium Frame, Sliding Doors to Terraces and Courtyards
Walls / Ceilings	Selected Paint Finish to Plasterboard
Courtyards / Terraces	Selected Tile
Security	Video / Audio Intercom
Laundry	European Laundry with Trough & Sink Mixer
Heating & Cooling	Ducted Air Conditioning & Ceiling Fans to Living and Bedrooms
Telephone / High speed Internet	One Point to Living Room and Main Bedroom
MATV / Pay TV	One Point to Living Room and Main Bedroom
Service Connections	Metered Electricity and Water
Carpark	Secure Carpark with Security Access Control System

* Or European Appliances of similar Quality.
The seller may substitute items contained in the schedule at any time without notice in accordance with the conditions of sale. The seller does not warrant the accuracy of the information provided in this schedule and is not responsible for any errors or omissions. The information is provided for general information only and should not be relied upon for any specific purpose. The seller does not warrant the accuracy of the information provided in this schedule and is not responsible for any errors or omissions. The information is provided for general information only and should not be relied upon for any specific purpose.



Seek Sanctuary

A stunning urban oasis. Revel in the
sanctuary created for you to indulge in.





ARTIST IMPRESSION

Resident's Lounge

Elevate your after-work drinks to a whole new level with a happy hour at home at your very own bar and lounge.



ARTIST IMPRESSION

Take control

Take control of your work and life, land the deal, look after your pooch and charge your car all from your doorstep.

ARTIST IMPRESSION



ARTIST IMPRESSION

Rooftop Pool

With a view worth an insta-moment, a stunning backdrop atop of Ruby Ruby is unrivaled.



SHOWER
SAUNA
PLUNGE POOL



ARTIST IMPRESSION



Sun, Soak, Steam

Create your own spa rituals with our deluxe sauna, a cold plunge pool and spend the day bathing in the infinity pool.

RR



ARTIST IMPRESSION



ARTIST IMPRESSION

Body, Mind & Soul

A gym and yoga studio with exclusive membership – You. Build the body, mind and soul in our purpose-built studio – no equipment needed.



ARTIST IMPRESSION



Dinner on High Rotation

With a view from high above deciding on
where to have dinner with friends is easy.

Seek Golden

A view unlike any other transporting you away from the everyday. Ruby Ruby will be the envy of many with a rooftop pool worthy of a sunset so golden.



Presented by



"We create addresses of distinction that people are proud to call home."

M. Stevens

Mark Stevens
Managing Director & Founder
Kokoda Property

Founded with a passion for architecture and a proud pioneering spirit, Kokoda Property creates living landmarks of craftsmanship, superior quality and thoughtful design.

Over the course of 25 years, our award-winning luxury residences have made the Kokoda Property name synonymous with quality and style, cementing our reputation as one of the most respected developers.

Ruby Ruby is Kokoda's second venture into the blossoming neighbourhood of Milton in Brisbane, following the success of our previous project, The Ambrose.

Our vision for Ruby Ruby is to create a standout collection of prestigious residences that will not only offer a truly extraordinary Brisbane lifestyle for those fortunate enough to call it home, but also positively contribute to the evolution of Milton and its vibrant community.



ARTIST IMPRESSION



RUBY RUBY

MILTON



To Arrange an Inspection, Contact:

RICHARD FUSS
0400 707 425

Wyatt & Fuss Real Estate
www.wyattfuss.com.au

